

**\$465,000**



*This Two Story Colonial Home has something for everyone. It features a nice foyer, formal living room with fireplace, formal dining room with built-in cabinets, eat-in kitchen with stainless steel appliances, family room with beamed ceiling, finished breezeway, master suite plus three other nice sized bedrooms, finished basement with game room, two full baths and one powder room, work shop, greenhouse, two car attached garage and a heated in-ground pool.*

## PROPERTY FEATURES

- Style: Colonial
- Bedrooms: 4
- Full baths: 2
- Part baths: 1
- Taxes: \$13,471
- Acres: .30
- Approximate age: 55
- Garage: 2 attached
- Basement
- Game room
- Fireplace
- Heated in-ground pool

**FOR MORE INFORMATION, VISIT THE WEB SITE:  
WWW.LVLREALTORS.COM/1020CONCORDCIRCLE**

**GARY VERMAAT**  
856.428.5150 EXT. 243  
FAX: 856.428.5185

GVERMAAT@LVLREALTORS.COM



**REGIONAL MAP**

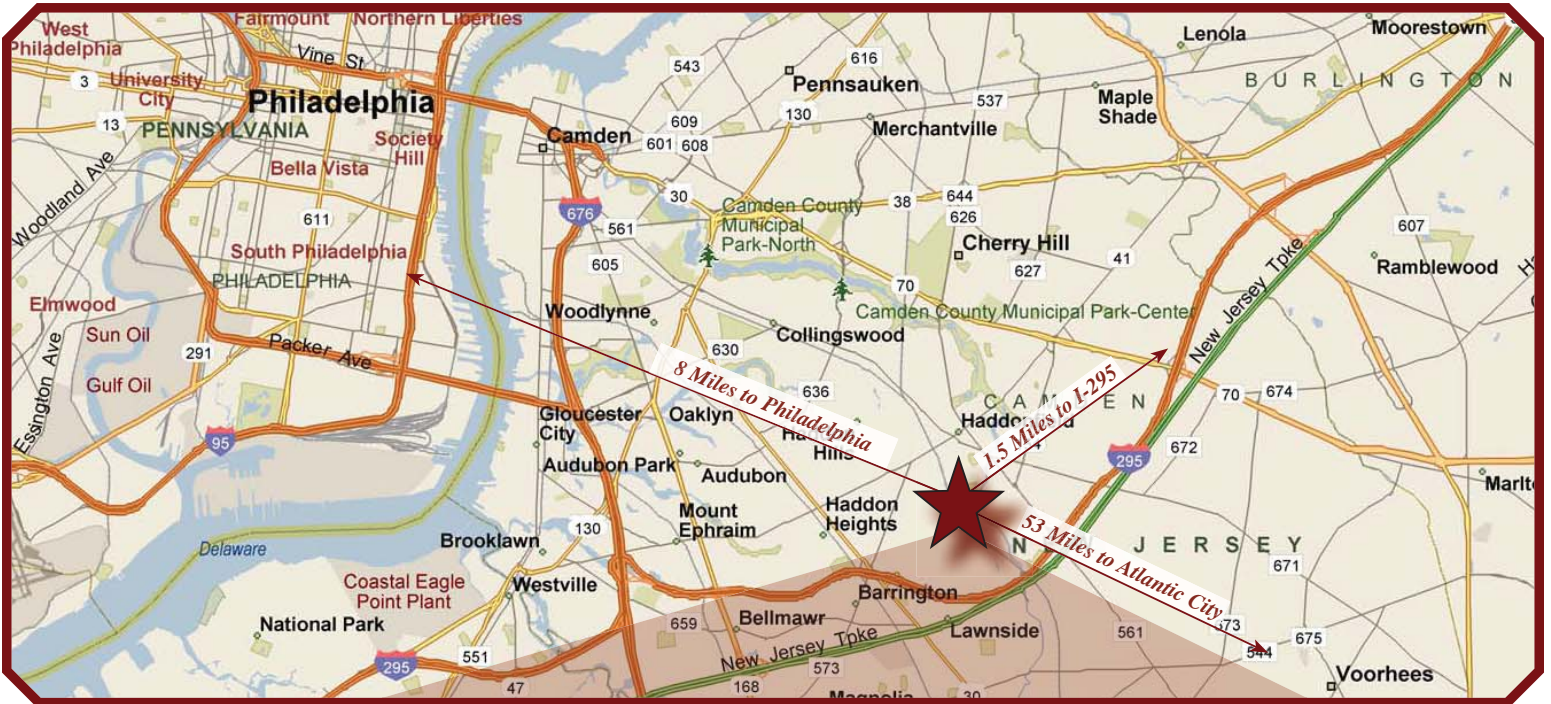

**NEIGHBORHOOD MAP**

**PROPERTY IMAGE GALLERY**

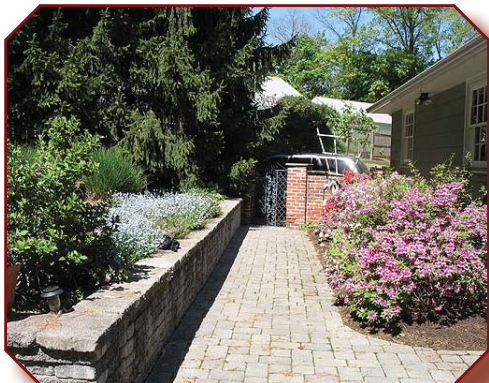
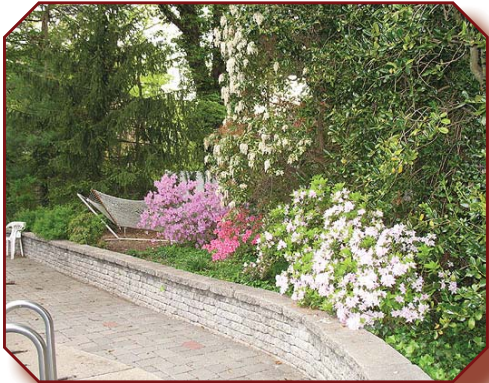

**PROPERTY IMAGE GALLERY**



**Front Porch**

Open, covered.

**Foyer (7'4" x 11'5")**

Hardwood floor.

**Living Room (17'1" x 11'7")**

Hardwood floor, crown molding, wood burning brick fireplace with Colonial mantle.

**Dining Room (11'9" x 11'5")**

Hardwood floor, crown molding, chair rail, two built-in corner cabinets, door to breezeway.

**Kitchen (11'4" x 12'5")**

Ceramic tile floor, crown molding, ceramic tile backsplash and countertops, chair rail, picture molding, double stainless steel sink, dishwasher, garbage disposal, electric wall oven, microwave, electric cook top, instant hot, trash compactor, recessed lights, butler's station, pantry, bow window.

**Family Room (23'5" x 13'2")**

Oak random width pegged hardwood floor, beamed ceiling, ceiling fan, wood blinds, walk-in closet.

**Breezeway (10' x 20')**

Ceramic tile floor, ceiling fan, crown molding, wainscoting, full view storm door.

**Greenhouse (15' x 9'5")**

**Attic**

Pull down steps, two attic fans.

**Garage**

2 car, attached, automatic garage door openers, driveway parking for 4 cars.

**In-Ground Pool**

Heated by propane, Polaris sweep cleaner, spa.

**Basement - Sump Pump - Outside Entrance to  
Greenhouse + Crawl Space**

**Game Room:** (20' x 10'7") Vinyl floor, recessed lights.

**Work Shop**

**Laundry Room:** Washer and dryer hook-ups, laundry tub.

**Bedrooms**

**Master Bedroom:** (16'7" x 11'8") Ceiling fan, hardwood floor, chair rail, walk-in closet.

**Second Bedroom:** (12' x 17'2") Wall-to-wall carpet over hardwood floor, closet, ceiling fan.

**Third Bedroom:** (10'5" x 11'5") Wall-to-wall carpet over hardwood floor, closet, ceiling fan.

**Fourth Bedroom:** (15'4" x 9'2") Hardwood floor, ceiling fan.

**Full Baths**

**Master Bath:** Ceramic tile floor, heat lamp, large stall shower, pedestal sink.

**Main Bath:** Ceramic tile floor, wainscoting and tub/shower surround, tub/shower combination, linen closet.

**Part Bath**

**Powder Room:** Ceramic tile floor, oak vanity.

**Additional Features**

- Exterior: Brick/Asbestos shingle
- Roof: Asphalt shingle, Timberline, new in 2001
- Heat: Gas, forced warm air
- Plumbing: Copper
- Air Conditioning: Central, new in 2001
- Wiring: 200 Amps, circuit breakers, new in 2001
- Hot Water Heater: Gas, 40 gallon
- EP Henry brick patio and retaining walls and walkways
- Trex deck
- 6 panel colonial doors
- Replacement windows throughout
- Outside spot lights
- Fenced rear yard, lawn sprinkler system
- Included: Washer, dryer, refrigerator
- Excluded: TV, Kegerator and refrigerator in breezeway, refrigerator in garage, light fixture over kitchen table

**FIRST FLOOR**

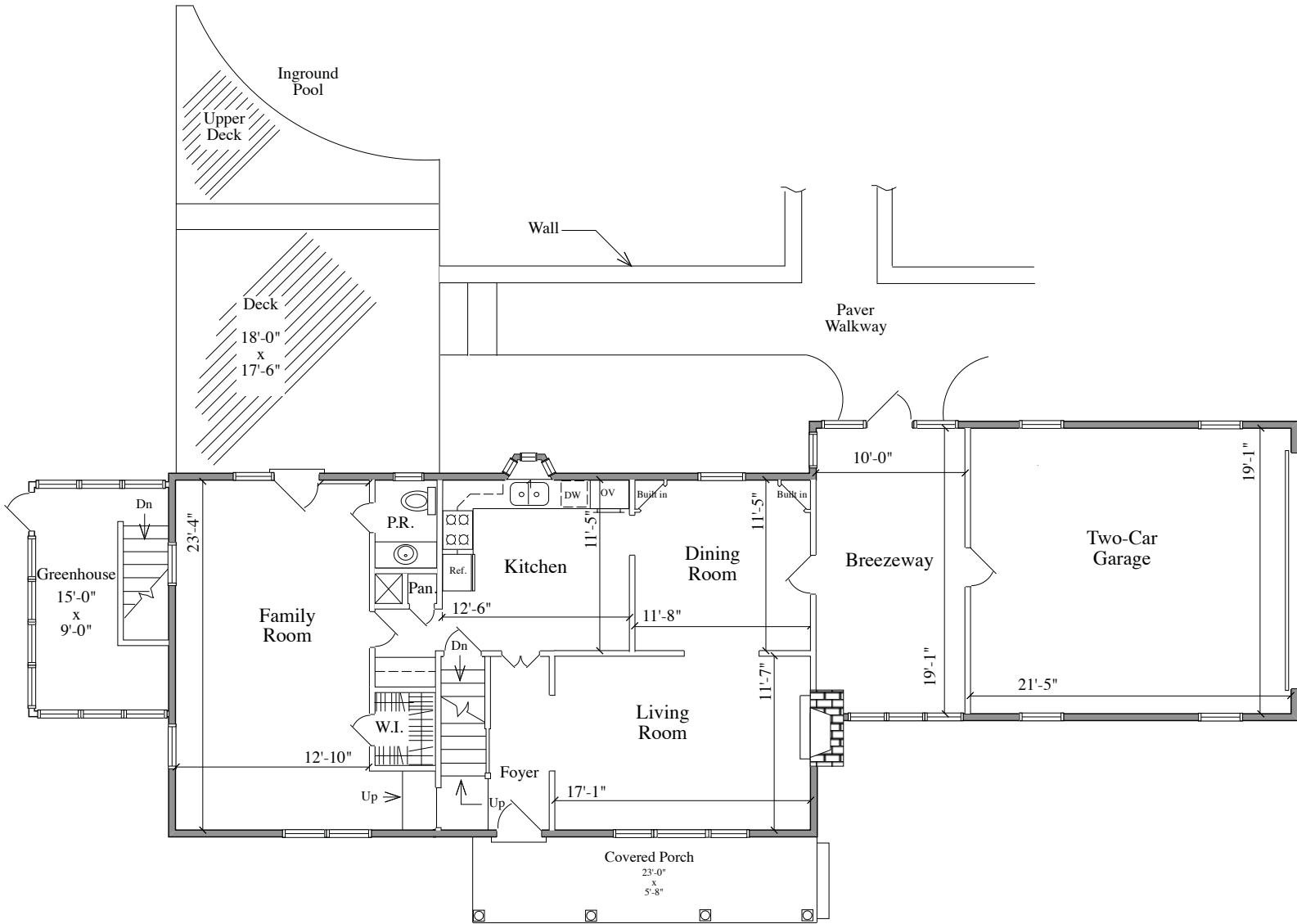

**SECOND FLOOR**

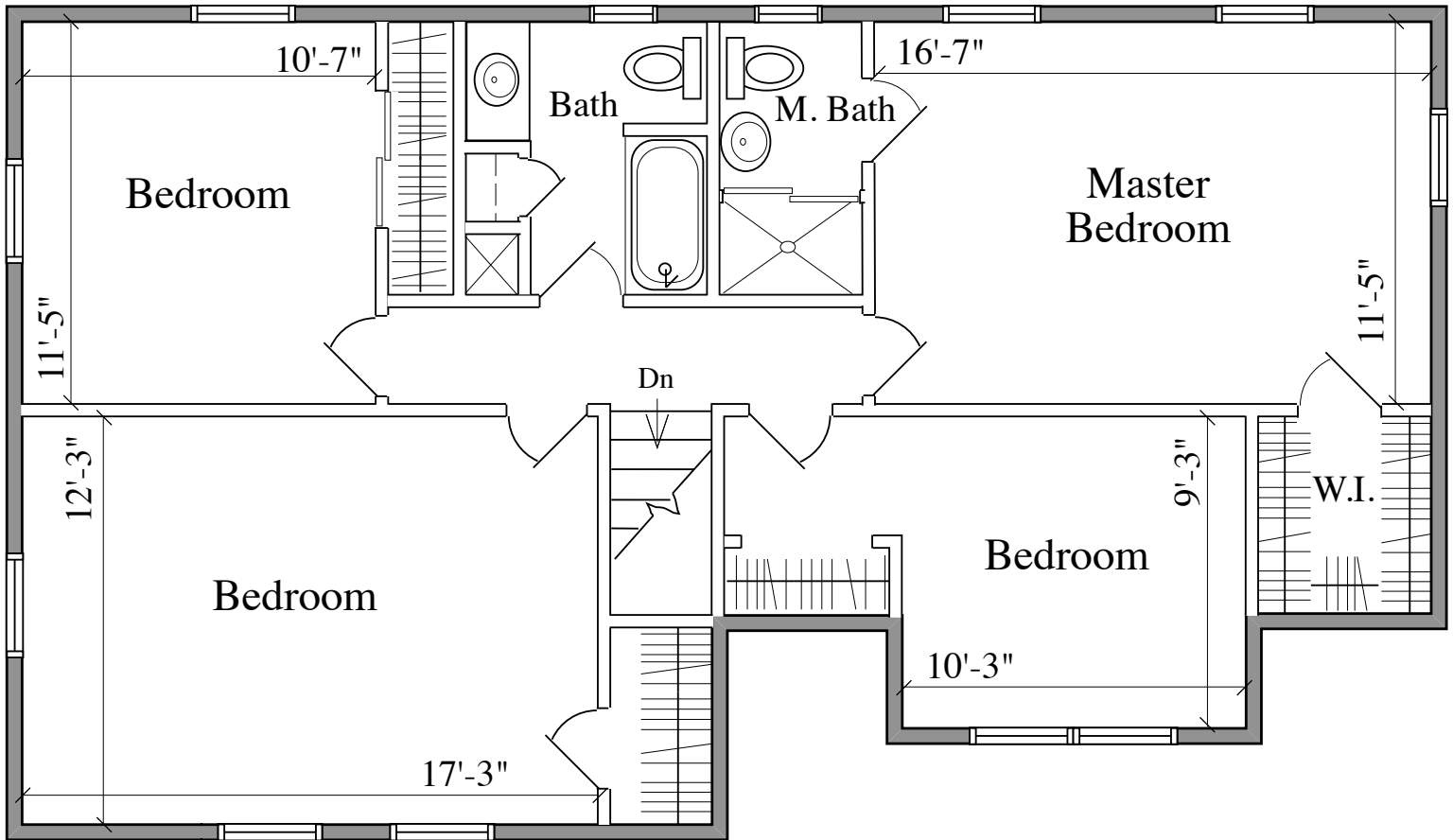

**BASEMENT**

